

# LED-Fassadenprofile LED-Konturbeleuchtung





## ● Produkteigenschaften

- einfache Installation
- geringer Stromverbrauch
- helle, gleichmäßige Ausleuchtung
- alle 55mm trennbar
- LED-Silikonbeschichtung
- Wärmeableitung des Aluminiumprofils
- keine Kondensations-Ablagerung
- Schutzklasse IP66
- PMMA bzw. Polycarbonate

### einzigartiges Profildesign

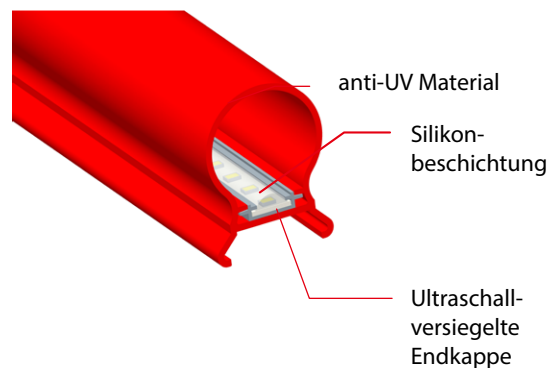

Standard-Einzelfarben oder Sonderfarben auf Wunsch

## ● Anwendungen

- Fassadenprofile
- Konturbeleuchtung
- Akzentbeleuchtung
- Pixelsteuerbare RGB-Beleuchtung



RoHS

LM-80  
TESTED





## ● Abmessungen (mm)

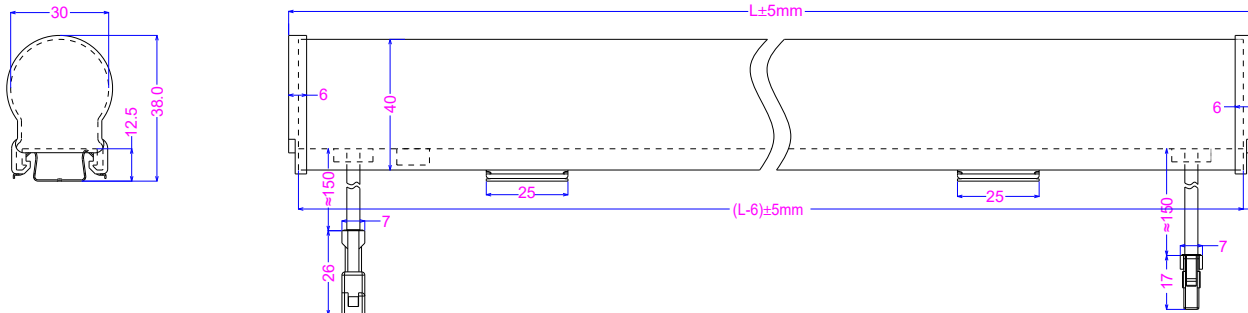

## ● Technische Daten

Artikel	Länge	IP	Spannung	Leistung	LED-Farbe	Gehäuse-Farbe	Helligkeit	trennbar	Temperatur
	2370mm	IP66	DC 24V	5,3W/m	weiß	weiß (RAL 9016)	1800cd/m <sup>2</sup>	55mm	-25 - 55°C
	2370mm	IP66	DC 24V	5,3W/m	rot	rot (PMS 1797 C)	300cd/m <sup>2</sup>	55mm	-25 - 55°C
	2370mm	IP66	DC 24V	5,3W/m	warmweiß	rot (PMS 1797 C)	300cd/m <sup>2</sup>	55mm	-25 - 55°C
	2370mm	IP66	DC 24V	5,3W/m	pink	pink (PMS Rubine Red C)	380cd/m <sup>2</sup>	55mm	-25 - 55°C
	2370mm	IP66	DC 24V	5,3W/m	grün	dunkelgrün (PMS 348 C)	580cd/m <sup>2</sup>	55mm	-25 - 55°C
	2370mm	IP66	DC 24V	5,3W/m	grün	hellgrün (PMS 7488 C)	1050cd/m <sup>2</sup>	55mm	-25 - 55°C
	2370mm	IP66	DC 24V	5,3W/m	blau	blau (PMS 285 C)	100cd/m <sup>2</sup>	55mm	-25 - 55°C
	2370mm	IP66	DC 24V	5,3W/m	weiß	hellblau (PMS 326 C)	980cd/m <sup>2</sup>	55mm	-25 - 55°C
	2370mm	IP66	DC 24V	5,3W/m	kaltweiß	citrusgelb (PMS 116 C)	1200cd/m <sup>2</sup>	55mm	-25 - 55°C
	2370mm	IP66	DC 24V	5,3W/m	warmweiß	gelb (PMS 2010 C)	1400cd/m <sup>2</sup>	55mm	-25 - 55°C
	2370mm	IP66	DC 24V	5,3W/m	warmweiß	orange (PMS 165 C)	700cd/m <sup>2</sup>	55mm	-25 - 55°C
	2370mm	IP66	DC 24V	5,3W/m	neutralweiß	rot/gelb zweifarbig	340/1500cd/m <sup>2</sup>	55mm	-25 - 55°C
	2370mm	IP66	DC 24V	5,3W/m	neutralweiß	blau/gelb zweifarbig	100/1250cd/m <sup>2</sup>	55mm	-25 - 55°C
	2370mm	IP66	DC 24V	max. 8,2W/m	RGB	RGB (RAL 9016)	R: 310cd/m <sup>2</sup> G: 720cd/m <sup>2</sup> B: 100cd/m <sup>2</sup> W: 1150cd/m <sup>2</sup>	145mm	-25 - 55°C
	2370mm	IP66	DC 24V	max. 8,2W/m	vollfarbe	vollfarbe (RAL 9016)		145mm	-25 - 55°C

- Befestigungsclips aus Edelstahl
- Konstantstrom-Technologie
- Anschlüsse IP67
- verschiedene Längen verfügbar: 2370mm, 1186mm, 600mm, etc.
- Mindestbestellmenge für pink, hellblau und blau/gelb zweifarbig = 500m



● Standard-Farben Endkappen



**RoHS**

LM-80  
TESTED



● Befestigungs-Clips

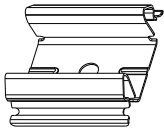

Schiebeclip

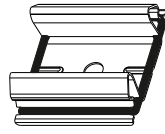

Schiebeclip, rutschfest

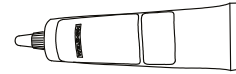

Reparatur Kleber

● Ecken und Verbinder (mm)

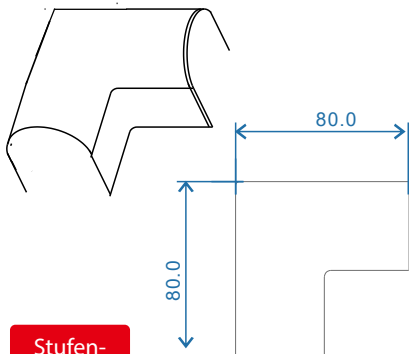

Stufen-  
Ecke

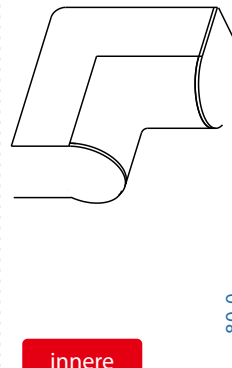
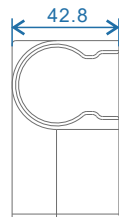

innere  
Ecke

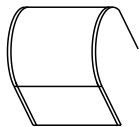
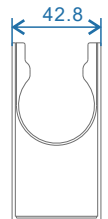
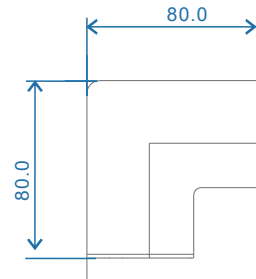

Verbinder

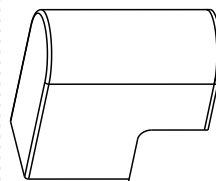
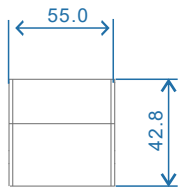

äußere  
Ecke

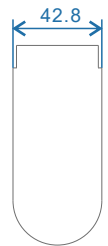
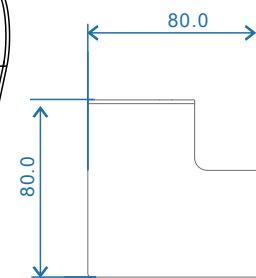

● Anwendungsbeispiele Verbindungskappen

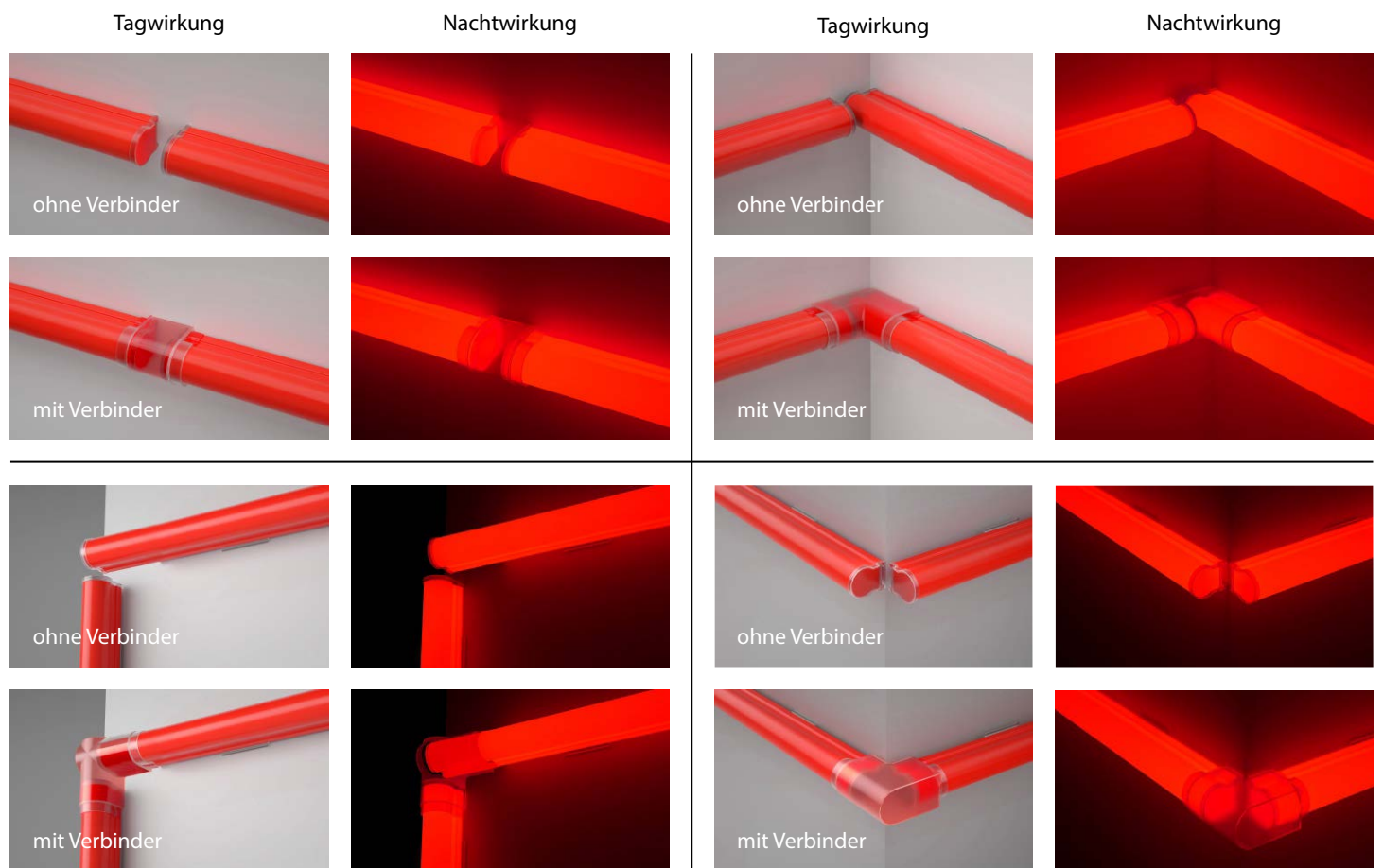

**RoHS**

LM-80  
TESTED



● **Verbinder mit Kabel**

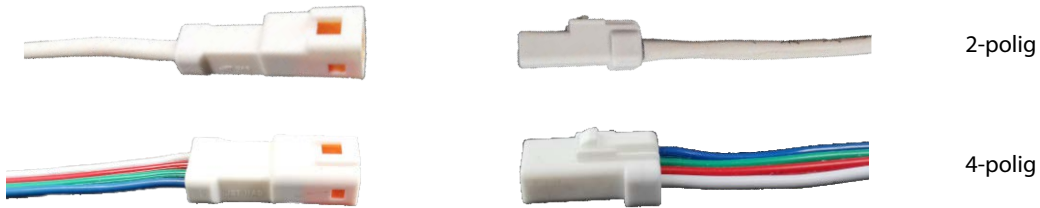

● **Kupplungen**



● **T/Y-Verbinder**



● **2-fach Verbindung**



● **Verbinder**

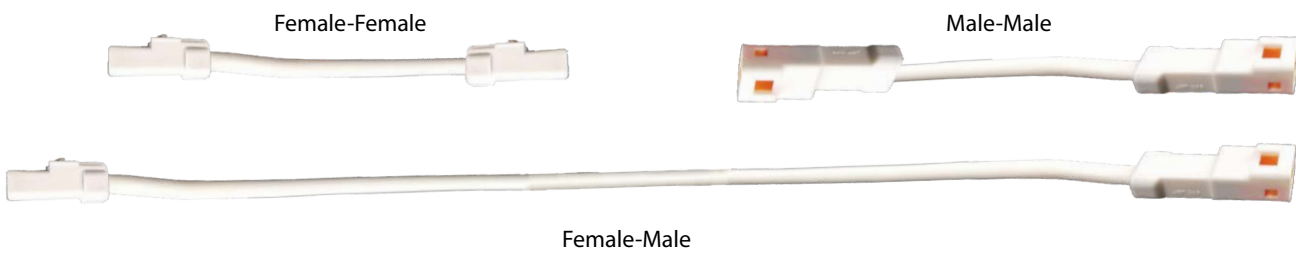

## ● Projekt-Beispiele



RoHS

LM-80  
TESTED

